

# Unità di potenza pneumo-idraulica – gruppi staccati

## Pneumo-hydraulic power unit – separated groups



### Gruppi cilindro UPC

### Cylinder groups UPC

6 potenze disponibili da 20 a 470 kN  
 pressione max entrata oil 400 bar  
 pressione aria max 9 bar  
 corsa 50 – 100 – 150 - 200 mm  
 modelli speciali a richiesta

6 powers available from 20 to 470 kN  
 400 bar max oil inlet pressure  
 9 bar max air pressure  
 50 -100 -150 - 200 mm strokes  
 special models under demand

#### DATI TECNICI E DIMENSIONI • SPECIFICATIONS AND DIMENSIONS

versione version	sforzo force kN	①	②	③	④
UPC.20	20 - 470	1/8	1/4	1/4	1/4
UPC.40			3/8	3/8	3/8
UPC.80			1/2	1/2	1/2
UPC.150					
UPC.300					
UPC.500			3/4	3/4	3/4

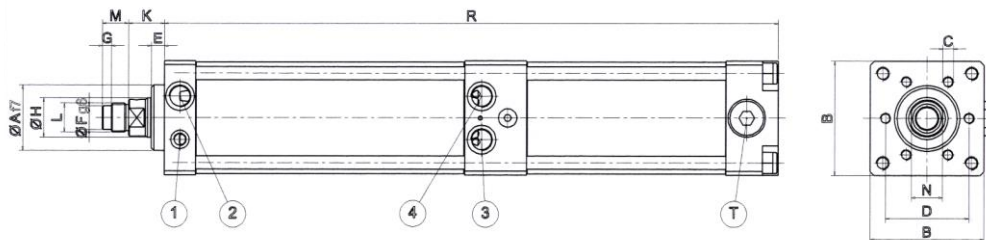
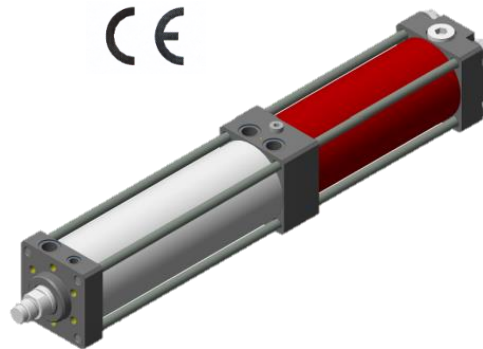

#### DATI TECNICI E DIMENSIONI • SPECIFICATIONS AND DIMENSIONS

versione version	potenza power kN	sezione di spinta thrust section cm <sup>2</sup>	ØA	B	C	D	E	ØF	G	ØH	K	L	M	N	T	R corsa stroke		
																050	100	200
UPC	20	4,90	40	71	6 M8	54	10	-	-	20	26	M16X1,5	15	16	1/2	246	346	546
	40	10,17	50	87		64		18	30	28,5	M22X2	20	24	250		350	550	
	80	19,62	70	111	6 M10	88		7	45	35	M30X2	25	36	3/4	277	377	577	
	150	38,46	75	136	6 M16	100	15	26	50	36		41	1" gas	289	389	589		
	300	78,5	100	170	6 M20	132	18	-	-	60	47	M39X2		35	52	352	452	652
	500	122,65	115	212	8 M20	150	25	-	-	65	52	M42X2		40	55	486	586	786